

CS120

WarmFloor Load Span Tables (m)

Dead Load (kN/m ²)	
1.80 (75mm Concrete topping)	
Partition Allowance (kN/m ²)	
0.50	1.00

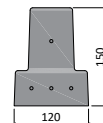

Self Weight = 31.9kg/m

"S616"

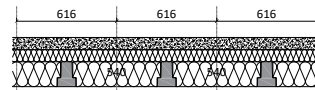

"S516"

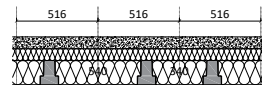

"S416"

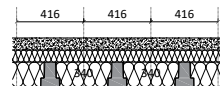

Configuration	Imposed Load (kN/m ²)					
	1.50	2.00	3.00	4.00	5.00	7.50
S616	4.305	3.875	3.520	3.005	2.615	1.970
S516	4.655	4.200	3.835	3.545	3.105	2.350
S416	5.105	4.630	4.235	3.920	3.670	2.900

CS160

WarmFloor Load Span Tables (m)

Dead Load (kN/m ²)	
1.80 (75mm Concrete topping)	
Partition Allowance (kN/m ²)	
0.50	1.00

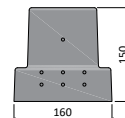

Self Weight = 48.0kg/m

Configuration	Imposed Load (kN/m ²)					
	1.50	2.00	3.00	4.00	5.00	7.50
S656	5.195	4.700	4.325	5.025	3.780	3.145
S556	5.565	5.055	4.660	4.345	4.085	3.590
S456	6.035	5.500	5.080	4.745	4.470	3.940

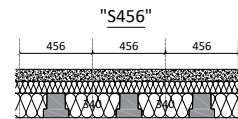
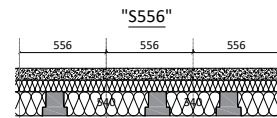
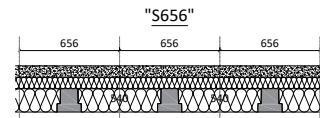

CS225

WarmFloor Load Span Tables (m)

Dead Load (kN/m ²)	
1.80 (75mm Concrete topping)	
Partition Allowance (kN/m ²)	
0.50	1.00

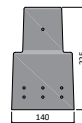

Configuration	Imposed Load (kN/m ²)					
	1.50	2.00	3.00	4.00	5.00	7.50
S628	6.635	6.035	5.570	5.125	4.500	3.445
S528	7.105	6.485	6.005	5.610	5.270	4.055
S428	7.695	7.055	6.550	6.140	5.795	4.920

